

## Door/Window Contact

# DS2300

User Manual

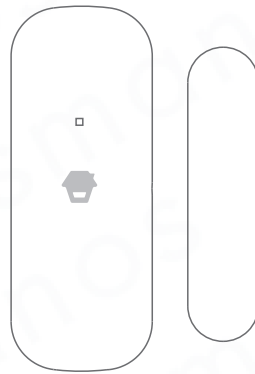

### LED Indication

**Flash once:** Intruder is detected.

**Flash once per 3 seconds after triggered:** Low battery. Replace the battery as soon as possible.

### PCB Layout

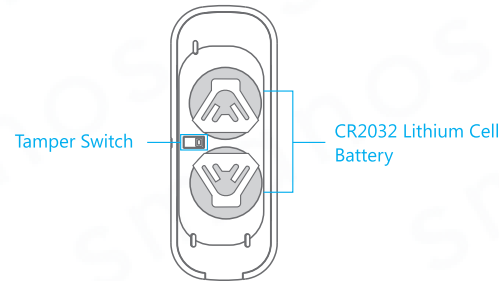

**Note:** When tamper switch is pressed, system will alarm immediately.

### Installation

After confirming that the door/window contact works properly, the installation steps can be proceed as follow:

Secure the transmitter and magnet on the desired locations (like door or window which can be opened and closed) with double-sided tapes.

**Note:** If this product is installed on a metal door, place spacers under the transmitter and magnet. This product is not suitable for shutter doors, please purchase shutter door sensor for your use.

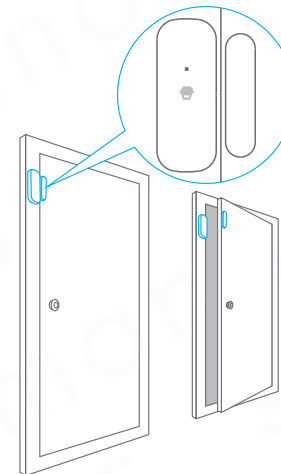

### Connect the Door/Window Contact

Connecting the door/window contact is to build a wireless connection between the door/window contact and the control panel.

1. Make sure the triangle mark is close to each other and within the range of 1cm.
2. Control panel enters into the connecting state (For details, please refer to the relative user manual).
3. Separate the transmitter and magnet with the space more than 2 cm, the control panel beeps once, indicating successful connection.

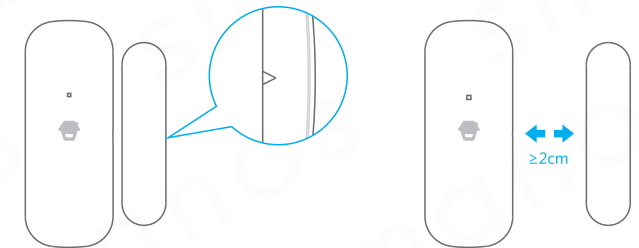

**Note:** If the control panel beeps twice when the above operation is done, it means the contact has been connected before.

### Specifications

**Power Supply:** DC 3 V (CR2032 lithium button cell battery x 2)

**Standby Current:** < 1  $\mu$ A

**Alarm Current:** < 10.5 mA

**Transmitting Distance:** < 80 m (Open area/ no interference)

**Radio Frequency:** 868 MHz or 915 MHz

**Housing Material:** ABS plastic

**Operation Condition:** Temperature: -10 °C~+55 °C

Relative Humidity: < 80% (non-condensing)

**Transmitter Dimensions:** 72.5 x 28 x 10 mm

**Magnet Dimensions:** 58 x 14 x 9.5 mm

### Introduction

The contact contains a transmitter and a magnet, which can be mounted on a door, window, or any object that can be opened or closed. When the transmitter and magnet are separated, the contact will send a signal to the control panel and the control panel will trigger an alarm. The tamper switch ensures that sabotage attempting to disassemble the contact will trigger an alarm.

### Overview

